



# 11 Volume Display

How to call tools From the SCP launcher → Click the "volume display " icon



Select the volume display icon

How to use After setting each item, click any position on the screen to arrange the volume display .

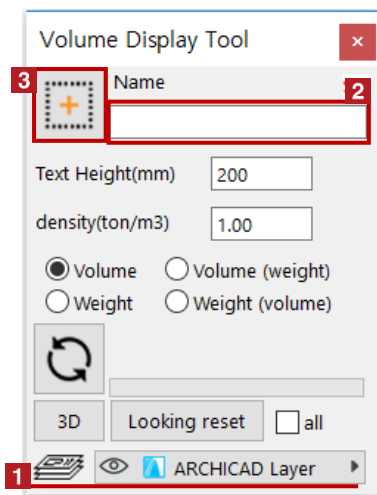

1 Select the object for volume and then select the layer to place

▶ 2D

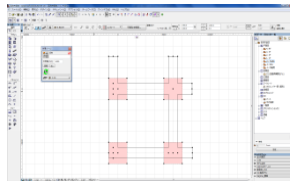

※ Multiple objects can be selected

▶ 3D

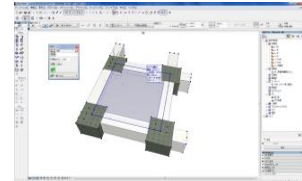

2 Specify any name

3 After clicking , click the position where you want to display the volume.

▶ 2D

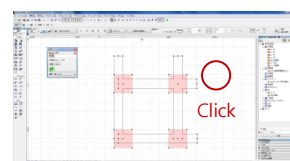

display



▶ 3D

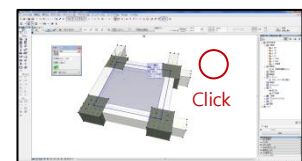

display



※ If you're looking for a view that indicates the volume of the object you want to calculate, it's useful to record the volume of the object you want to display.



## How to edit

You can change the display contents and display direction of the placed volume display object.

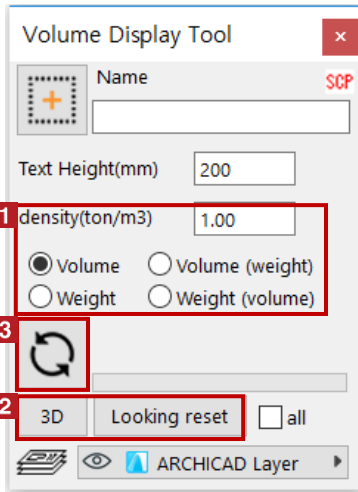

### 1 Changing display content

Select the volume display object you want to change, enter the specific gravity according to the contents of display (volume, weight, etc.), then specify the contents to display

Select volume display object

Enter specific gravity and specify display content

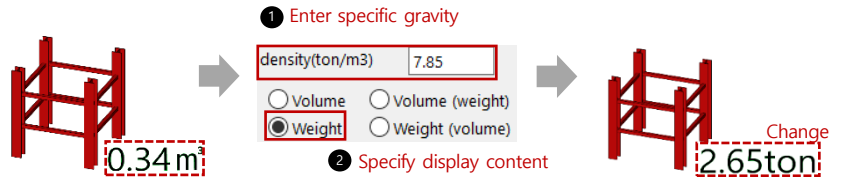

### 2 Change display direction

Select the volume display object you want to change and click **3D** (**Looking reset** will return you to the default position).

Select volume display object



### 3 Update calculation results

Select the volume display object you want to update and click on

Select volume display object

